

# **Outlander**

Designed for comfort, control and durability on bitumen  
and graded dirt roads,  
THE ALL NEW OUTLANDER IS SURE TO PLEASE

**SEMI OFF ROAD**  
C A R A V A N



# **highlander**

ESSENTIAL HIGHLANDER OFF ROAD CARAVANS  
Because a "tough-as" caravan should still look damn good.

**OFF ROAD**  
C A R A V A N



essential  
CARAVANS



# GET SET FOR YOUR ESSENTIAL ADVENTURE!

When building off road caravans you need to consider many things. Experience tells us that free camping is a must, battery management systems, solar panels, piano hinged doors, grey tank, independent suspension with extra ground clearance and self sufficient water supply gives you the ability to choose how you enjoy your caravanning experience. With Essential Semi Off Road and Off Road Caravans we think we have you covered.

We also give you two choices of the off road experience to choose from.

The 'Outlander' built for the not so serious explorer who still wants a level of freedom to explore and wander the land, to still have the ability and confidence to turn off the bitumen and wander down a dirt road or two to explore that little fishing spot you've heard about.

And the mighty 'Highlander' set to travel the Gibb or cross the plains during your big lap, your covered with this tough beast of a van\*. You choose which model best suits your needs and we'll do the rest.

Essential Caravans is a great Australia success story. The culmination of over 35 years hands on experience in the caravan industry in Australia.

Breaking the mould of traditional manufacturer based thinking, the thinking behind Essential Caravans comes from a dealer background, a customer service background, a listening and taking the time to learn from the customers instead of telling them background.

We enjoy caravanning as much as you do and want you to have the best possible experience, we spend time away in our vans to confirm what we are doing is working. This is Essential Caravans promise to you.

See for yourself at your nearest authorised Essential Caravans dealership.

We know you'll love an Essential Caravan just as much as we do.

\*Note: See disclaimer for more information pertaining to warranty and conditions of use.





**SEMI OFF ROAD**  
CARAVAN

## THE OUTLANDER

Designed for comfort, control and durability on bitumen and graded dirt roads the all new Outlander is sure to please.

The Essential Outlander Caravan is designed for the caravan traveller wanting to get away without going all the way.

Experience tells us that not all caravan travellers want to stay exclusively on the 'bitumen', some want the ability to travel and explore down the odd dirt track or two. If this sounds like you then this could be your caravan.

Even suitable for use on light corrugated roads for short distances the all new Essential Outlander is what we like to call our "Semi Off Road" Caravan.

Inspect one today and you'll soon be getting away...



## INTERNAL

- Smoke Detector
- Fire Extinguisher
- Innerspring Queen Mattress 5' x 6'2'
- Mirror in Ensuite
- Grab Handle on Entry Wall at Door
- Drawers on Metal Runners
- Full Laminate Splashback & Benchtops
- 2 Single Towel Rails and 1 Toilet Roll Holder
- Cutlery tray
- Piano Door Hinges
- Bedspread
- Infill Panels
- Shelf and Mirror above Bedhead  
(not applicable to all models - check with your dealer)
- Padded Lift Up Footrest and Access Door to under couch  
(not applicable to all models - check with your dealer)
- Robe Recessed Cutout with Separate compartment  
(not applicable to all models - check with your dealer)

## EXTERNAL

- Insulated Roof and Walls with Meranti Timber Frame
- Granite (black) Roll Out Awning (size to suit van)
- Double Glazed Push Out Windows & Integrated Blinds
- Galvanized Front Tunnel Boot with Large Access Doors
- Galvanised Lined Generator Compartment (excludes Designs 1D, 1F, 2-1, 10 and Family Layouts)
- (Note: Family Design 2-6 does include Gen Compartment)
- Black External Trim
- Multi Point Locking Main Door with Security Mesh
- LED Roof Skylights with Blind & Flyscreen
- Grab Handles to Each Corner of Van
- External Fold Down Picnic Table
- Checker-Plate Step
- Smooth Silver High Profile Aluminium Cladding
- Heritage Grey Comp Panel Upper Front To Roll
- Black Checker-Plate Front Sides & Rear (600mm High)
- Black Aluca Bond above checkerplate Rear to roof
- J/Mould Wheel Spat
- Quality Digital Print Decals

## CHASSIS

- 6" Heavy Duty Chassis
- 6" A-Frame Return to Spring Hangers
- A/Frame extended 450mm
- Tool Box 2 Jerry can holders
- 235/75 R15 All Terrains & 15" Alloy Wheels
- 8" Jockey Wheel
- Wind Up Jack
- DO35 Coupling
- Heavy Duty 3 Arm Bumper
- Spare Wheel Fitted to Bumper Bar Bolt On
- Aluminium Pull Out Step
- 10" Electric Brakes (Tandem Axle)
- 12" Electric Brakes (Single Axle)
- A-Frame Tap & Gas Regulator
- Drop Down Stabilizer Stands
- Break Away System
- Galvanized Wheel Arches
- Galvanised Stoneguards to Water Tanks
- ALKO Enduro 'Cross Country' single shock 3.3T Ind. Susp. (tandem axle)
- ALKO Enduro 'Outback' twin shock 2.7T Ind. Susp. (single axle)
- Batteries mounted on Chassis (Off Side)

## PLUMBING

- Mains Pressure Water Inlet
- Waste Water Outlet
- 2 x Lockable Water Tank Inlet
- 2 x 95L Water Tanks
- Twin digital Water Level Gauges
- Dual 9Kg Gas Bottles with Changeover Regulator
- A-Frame Mains Pressure Tap
- External Gas Bayonet At Front Boot Door Side
- China Vanity to Ensuite
- Porcelain Bowl Toilet
- Flick Mixer Taps
- Large Deep Bowl Stainless Kitchen Sink with Drain
- Water Filter to Sink with Separate Tap
- Gas/Electric Hot Water System
- 12V Water Pump
- 2 Door 3 Way Fridge Freezer
- Grey Water Tank
- Recessed Cook Top with Lid over Stove

## ELECTRICAL

- Bulk Heads with LED strip lights
- LED External Lights
- Battery Pack incl. BMPRO PM,
- 2 x 100Amp AGM Batteries (chassis mounted)
- Digital Roof Top TV Antenna
- 24" Flat screen TV on Wall Mounted Bracket
- CD/Radio Player with Bluetooth capabilities
- 2 x Internal Roof Speakers
- 2 x External Marine Speakers
- 12 Pin Trailer Plug with Charging & Fridge Capabilities
- Full Oven/Grill with 3 Burner Gas & 1 240V Element
- Power Points (1x Kitchen, 1x Ensuite, 2x Bedroom)
- USB Points (2 x Wardrobe, 1 x Lounge)
- 240V 15AMP Inlet & 240V 10AMP Outlet
- Circuit Breaker & Earth Leakage Protection
- 2 x 160W Solar Panels on Roof with 30A Regulator
- Reversing Camera & Car Monitor Kit
- 12V/USB Socket & TV Point at Dining Table and Outside Table
- LED Lighting - Roof, Kitchen, Ensuite
- 2 LED Reading Lights in Bedroom
- 2 LED Reading Lights in Lounge
- 1 LED Annexe Light
- Door Light & Entry Handle
- 12V Fan hatch to toilet and Shower
- Top Loader Washing Machine  
(note: Design 2 fitted with Wall Mount WM)  
(note: Washing Machine Not Standard Designs 1D, 1F)  
(note: Design 9 fitted with Front Loader WM)  
(note: Washing Machine Not Standard in Family layouts)
- 3 Way Gas/Elect Fridge with Sep. Freezer.  
Tropical Rated
- Standard fridge size 190L total
- 12 V Range Hood
- IBIS MK4 Roof Air Conditioner  
(or equivalent AC)
- Microwave oven



# highLANDer

**OFF ROAD**

CARAVAN

## THE HIGHLANDER

Essential Highlander Off Road Caravan, because a tough-as caravan should still look damn good.

Sitting on a solid 6 inch Aussie built galvanised steel chassis and riding on the now famous ALKO Enduro "Outback" independent twin shock suspension we think we've got your off road adventure pretty much covered.

Featuring over 320 watts of Solar as standard, Grey tank, Piano Hinges, digital 'Trek' monitoring display for Power, Water and Solar, big Tool Box with Jerry Can holders and 'Jenny' slide out just to name a few of the standard inclusions, you know this caravan is purpose built for Off Road enjoyment.

Think style, think luxury and expect genuine toughness to take you where you want to go, then think the Essential Highlander Off Road Caravan.



## INTERNAL

- Smoke Detector
- Fire Extinguisher
- Innerspring Queen Mattress 5' x 6'2'
- Mirror in Ensuite
- Grab Handle on Entry Wall at Door
- Drawers on Metal Runners
- Full Laminate Splashback & Benchtops
- 2 Single Towel Rails and 1 Toilet Roll Holder
- Cutlery tray
- Piano Door Hinges
- Bedspread
- Infill Panels
- Shelf and Mirror above Bedhead  
(not applicable to all models - check with your dealer)
- Padded Lift Up Footrest and Access Door to under couch  
(not applicable to all models - check with your dealer)
- Robe Recessed Cutout with Separate compartment  
(not applicable to all models - check with your dealer)

## EXTERNAL

- Insulated Roof and Walls with Meranti Timber Frame
- Granite (black) Roll Out Awning (size to suit van)
- D Flector Stone Guard
- Double Glazed Push Out Windows & Integrated Blinds
- Galvanized Front Tunnel Boot with Large Access Doors
- Galvanised Lined Generator Compartment (excludes Designs 1D, 1F, 2-1, 10 and Family Layouts)
- (Note: Family Design 2-6 does include Gen Compartment)
- Black External Trim
- Multi Point Locking Main Door with Security Mesh
- LED Roof Skylights with Blind & Flyscreen
- Grab Handles to Each Corner of Van
- External Fold Down Picnic Table
- Checker-Plate Step
- White Composite Panel Cladding (1350mm High) Front, Rear and Sides
- Black Checker-Plate Front, Sides & Rear (800mm High)
- Checker plate Wheel Spats
- Quality Digital Print Decals

## CHASSIS

- 6" Heavy Duty Chassis
- 6" A-Frame Return to Spring Hangers
- 2" Raiser
- A/Frame extended 450mm
- Tool Box 2 Jerry can holders including Generator Slide Out
- 265/75 R16 Mud Terrain Tyres
- 16" Mainline Matte Black Wheels
- 8" Jockey Wheel
- Wind Up Jack
- DO35 Coupling
- Heavy Duty 3 Arm Bumper
- Spare Wheel Fitted to Bumper Bar Bolt On
- Aluminium Pull Out Step
- 12" Electric Brakes to All Wheels
- A-Frame Tap & Gas Regulator
- Drop Down Stabilizer Stands
- Break Away System
- Galvanized Wheel Arches
- Galvanised Stoneguards to Water Tanks
- ALKO Enduro 'Outback' Twin Shock (2.7T Single) (3.7T Tandem) Ind. Susp.
- Batteries mounted on Chassis (Off Side)

## PLUMBING

- Mains Pressure Water Inlet
- Waste Water Outlet
- 2 x Lockable Water Tank Inlet
- 2 x 95L Water Tanks
- Water Level Gauges (Trek Display)
- External Shower
- Dual 9Kg Gas Bottles with Changeover Regulator
- A-Frame Mains Pressure Tap
- External Gas Bayonet At Front Boot Door Side
- China Vanity to Ensuite
- Porcelain Bowl Toilet
- Flick Mixer Taps
- Large Deep Bowl Stainless Kitchen Sink with Drain
- Water Filter to Sink with Separate Tap
- Gas/Electric Hot Water System
- 12V Water Pump
- 2 Door 3 Way Fridge Freezer
- Grey Water Tank
- Recessed Cook Top with Lid over Stove

## ELECTRICAL

- Bulk Heads with LED strip lights
- LED External Lights
- LED Work Lights - Front, Rear and Off Side
- 12V Socket located above Off Side Wheel
- Battery Pack incl. BMPRO SR with Trek Display,
- 2 x 100Amp Hour AGM Batteries (chassis mounted)
- Digital Roof Top TV Antenna
- 24" Flatscreen TV on Wall Mounted Bracket
- CD/Radio Player with Bluetooth capabilities
- 2 x Internal Roof Speakers
- 2 x External Marine Speakers
- 12 Pin Trailer Plug with Charging & Fridge Capabilities
- Full Oven/Grill with 3 Burner Gas & 1 240V Element
- Power Points (1x Kitchen, 1x Ensuite, 2x Bedroom)
- USB Points (2 x Wardrobe, 1 x Lounge)
- 240V 15AMP Inlet & 240V 10AMP Outlet
- Circuit Breaker & Earth Leakage Protection
- 2 x 160W Solar Panels on Roof with 30A Regulator
- Reversing Camera & Car Monitor Kit
- 12V/USB Socket & TV Point at Dining Table and Outside Table
- LED Lighting - Roof, Kitchen, Ensuite
- 2 LED Reading Lights in Bedroom
- 2 LED Reading Lights in Lounge
- 1 LED Annex Light
- Door Light & Entry Handle
- 12V Fan hatch to toilet and Shower
- Top Loader Washing Machine  
(note: Design 2 fitted with Wall Mount WM)  
(note: Washing Machine Not Standard Designs 1D, 1F)  
(note: Design 9 fitted with Front Loader WM)  
(note: Washing Machine Not Standard in Family layouts)
- 3 Way Gas/Elect Fridge with Sep. Freezer.  
Tropical Rated
- Standard fridge size 190L total
- 12V Range Hood
- IBIS MK4 Roof Air Conditioner (or equivalent AC)
- Microwave oven





VAN 1C - 15'

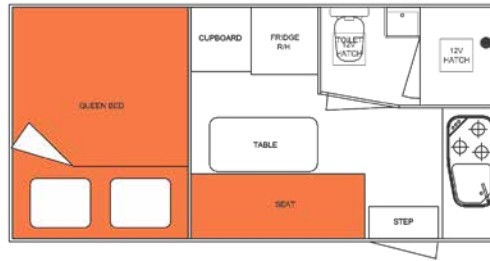

VAN 1D - 15'

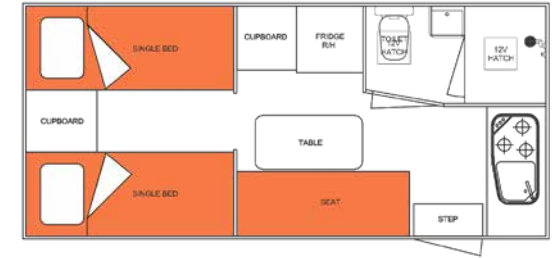

VAN 1F - 16'



VAN 2-1 - 19'



VAN 4 - 19'8"



VAN 5-1 - 20'6"

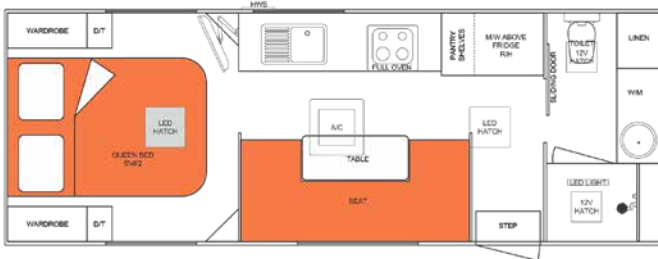

VAN 7 CLUB - 21'6"



VAN 7-1 - CLUB 21'6"

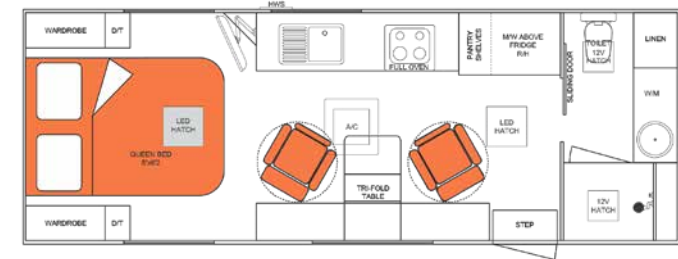

VAN 7 RECLINER - 21'6"



VAN 10 - 22'10"



VAN 1JF - 17'6"

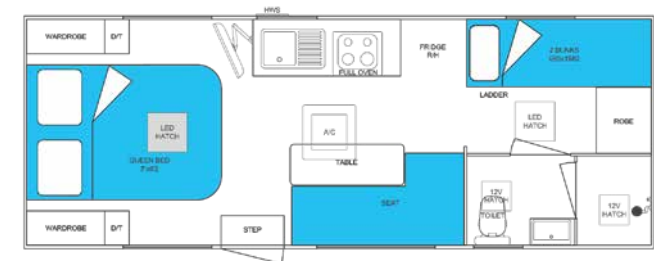

FAMILY 2 - 21'

# FLOOR PLANS & LAYOUTS



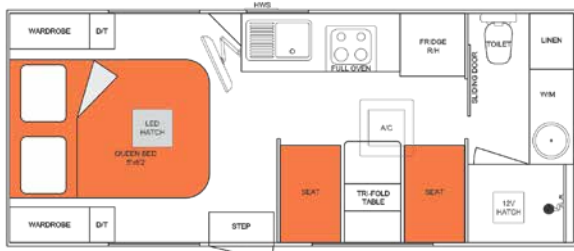

VAN 1 - 18'6"

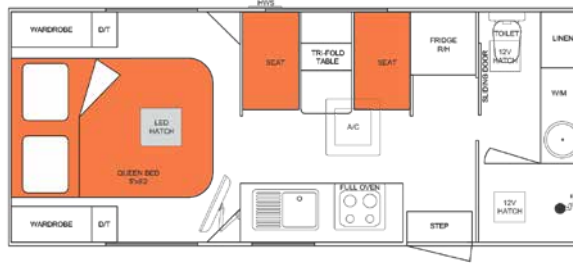

VAN 1-1 - 18'8"

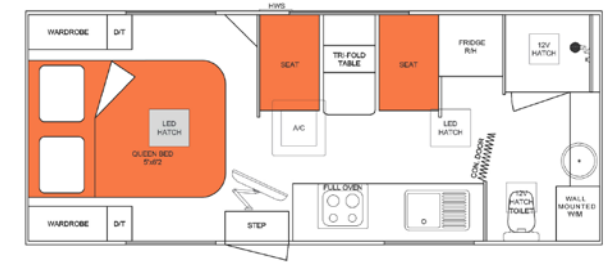

VAN 2 - 19'



VAN 5-2 - 20'6"

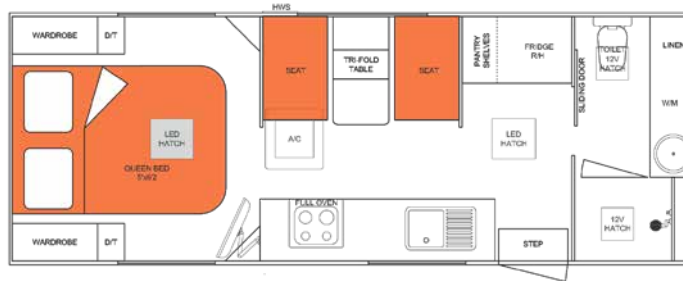

VAN 6 - 21'



VAN 6-1 - 21'

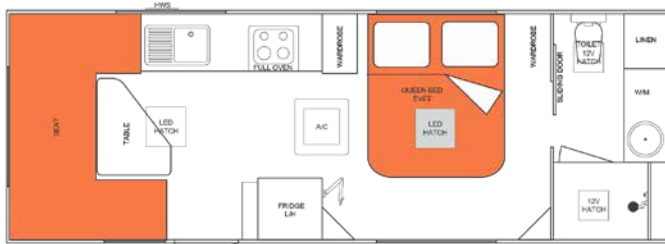

VAN 8 CLUB 21'10"

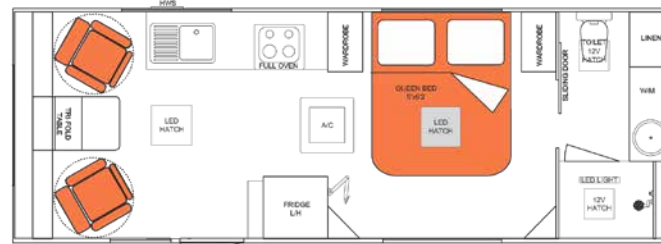

VAN 8 RECLINER - 21'10"



VAN 9 - 21'10"

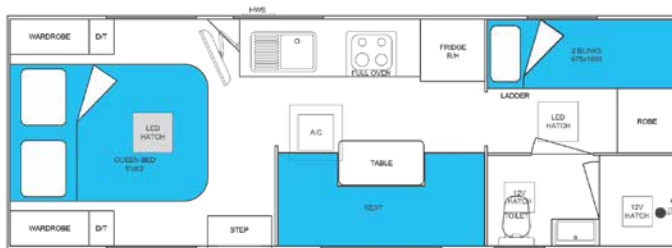

FAMILY 2-5 - 21'10"



FAMILY 2-6 - 21'10"

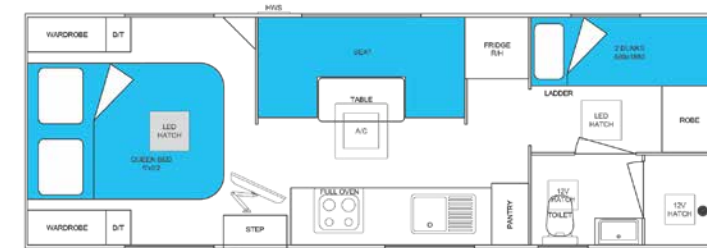

FAMILY 3 - 22'10"

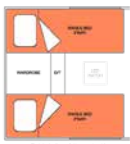

SINGLE BED OPTION

# OUR PARTNERS

We Only Use Trusted Leading Industry Products and Suppliers.



## AL-KO BRAKES & AXLES

Globally recognized by caravanners around the world, AL-KO is recognised as the pioneer in the manufacturer of brakes and axles specifically designed for caravans and motor homes.



## DOMETIC GROUP FRIDGES & AWNINGS

A leading international supplier of refrigerators, awnings, roof hatches, toilets and other premium comfort accessories for the caravan, motor home and RV market here in Australia and overseas.



## ATRV AUSSIE TRAVELLER

A 100% Australian owned company specializing in manufacturing and distributing products such as, awnings and annexes and other essential caravan and touring components.



## NCE ELECTRICAL TIMBERS AND WHITE GOODS

For over 25 years NCE has been supplying the RV industry with a range of timbers and electrical accessories. DesignRV have forged a strong business relationship, resulting in a range of innovations, custom products and exclusive options for our customers.



## THETFORD OVENS & COOKTOPS

A well established brand for over 40 years. A world market leader in refrigerators and cooking equipment to the RV industry. Thetford uses the highest quality materials and thoroughly tests each appliance to ensure its ultimate safety - and performance.



## MAKING ANYWHERE HOME

At Camec, we live to create outdoor comfort wherever the road may take you. With an online store, retail outlets and stockists across Australia and New Zealand, we have all the parts and accessories when, and where, you need them to make your RV and caravan experience feel just like home.



Essential Off Road and Semi Off Road caravans including but not limited to; 'Outlander' - 'Highlander' - 'ATX' - 'ATX Xtreme' off-road range of caravans and also including 'Upgraded Independent Suspension' Touring caravans, have been designed and constructed to give added strength and ground clearance, For limited unsealed road usage. Gas venting regulations and other construction restraints limit the effectiveness of these caravans against dust and water penetration. Under no circumstances should these caravans be exposed to water crossings at, or above, body floor level. Essential Caravans strongly recommend towing at a safe speed according to travel conditions with extra care and attention required on uneven surfaces. Essential Caravans off-road caravans are not designed for hard impact or heavy landings or severely rutted roads or tracks. Semi Off Road 'Outlander' and 'ATX' Models are not designed for any surface other than sealed or graded gravel and graded dirt roads. Under no circumstances are Semi Off Road models to be taken over corrugations or rutted roads. Off Road and Semi Off Road Essential Caravans are not designed for use on 'Four Wheel Drive Only' tracks under any circumstances.





**NATIONAL MANUFACTURING & DEALER DISTRIBUTION CENTRE**  
**68 - 74 National Boulevard, Campbellfield, Victoria AUSTRALIA 3061**

ESSENTIAL Caravans are Proudly 100% Australian Owned and Made 

(03) 9357 7934

[www.essentialcaravans.com](http://www.essentialcaravans.com)

 [essentialcaravansau](https://www.facebook.com/essentialcaravansau)

 [essentialcaravansau](https://www.instagram.com/essentialcaravansau)



All information contained in the brochure was correct at the time of printing and is subject to change without notice. Photographs for illustration purposes only and may show some non standard items or features. Standard features may change due to ongoing product improvement and availability. Talk to your dealer today.